

ITEM	NO.	QTY.	DESCRIPTION
3	511003	1	SPACER
5	511005	4	SPLICE PLATE
6	511006	1	4' TRACK & SPLICE PLATES
7	511007	1	8' TRACK & SPLICE PLATES
8	511008	1	16' TRACK & SPLICE PLATES
9	511009	1	16' TRACK & SHOES
10	511010	4	PLATE
11	511011	6	SMALL BUSHING
12	511012	6	SMALL WHEEL
13	511013	2	MEDIUM BUSHING
14	511014	2	MEDIUM WHEEL
15	511015	6	LARGE BUSHING
16	511016	6	LARGE WHEEL
17	940185	10	TROLLEY WHEEL
18	941410	2	SHOES
19	921721	1	TOP SHEAVE
20	915054	1	SHACKLE
30	511030	1	PLATFORM 250 LBS.
40	511040	1	TOP SHEAVE BRACKET & TOP SHEAVE
41	511041	1	TOP SHEAVE BRACKET
50	511050	1	250 LBS. GRAVEL HOPPER (OPTION)
100	910362	1	BOLT,HEX.
101	913515	1	LOCK-NUT
102	910159	2	BOLT,HEX.
103	913507	2	LOCK-NUT
104	910152	4	BOLT,HEX.
105	912503	4	LOCK WASHER
106	913007	4	NUT,HEX.
107	911152	32	CARRIAGE BOLT
108	913599	8	LOCK NUT
109	913407	8	WING-NUT
110	912503	8	LOCK WASHER
111	910051	8	BOLT,HEX.
112	910104	2	BOLT,HEX.
113	913003	8	NUT,HEX.
114	912501	8	LOCK WASHER
115	913505	2	LOCK-NUT
116	937005	2	SPRING
117	912002	4	WASHER
500	511500	1	POWER UNIT (4 HP.)
	512500	1	POWER UNIT (5.5 HP.)

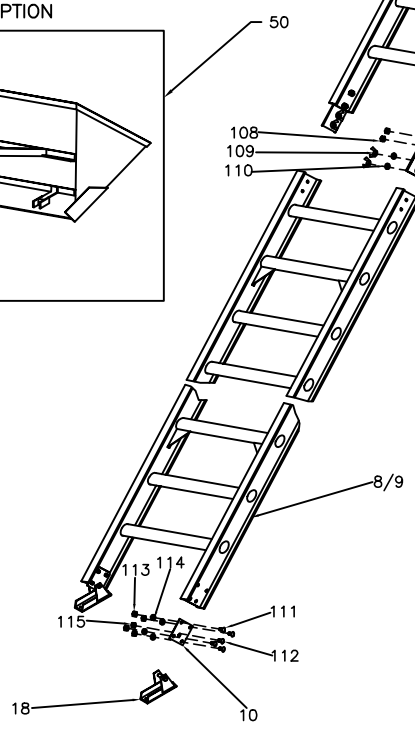
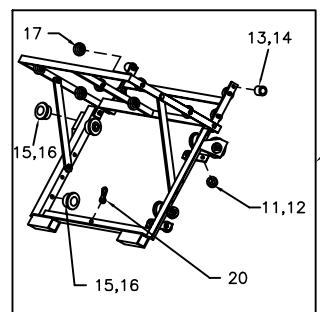
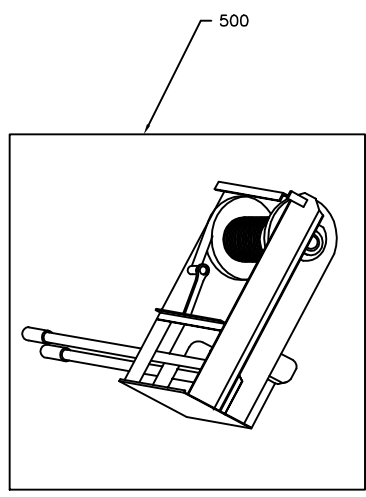
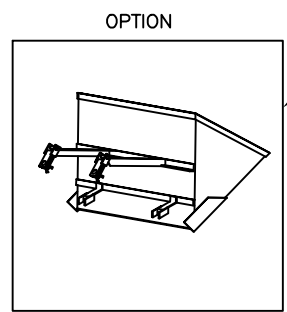
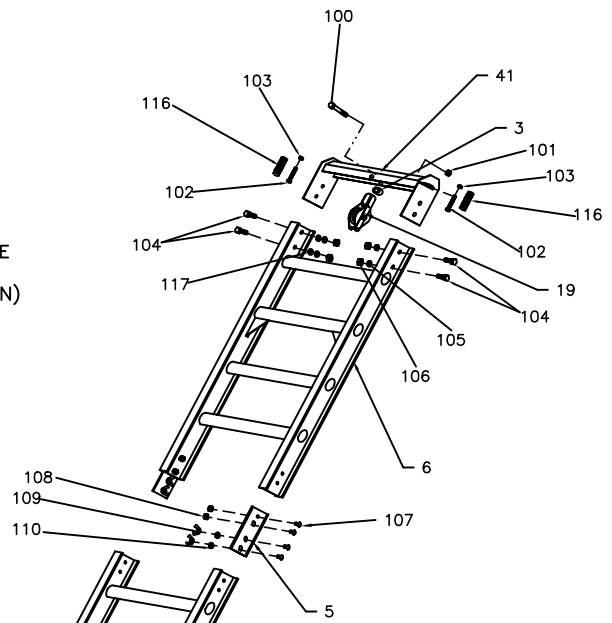
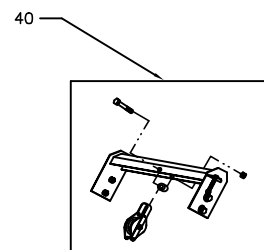

DATE:	04.10.1999	250 LADDER HOIST
REV.:	06.01.2007	
EQUIPMENT GRIZZLY EQUIPMENT		511000